

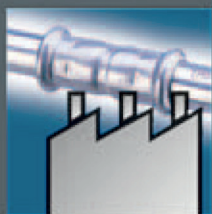

FONTANERÍA



INDUSTRIA



ENERGÍA SOLAR

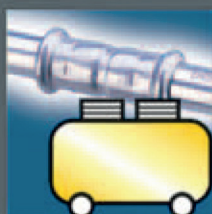

AIRE COMPRIMIDO



CALEFACCIÓN



CLIMATIZACIÓN



RED INCENDIOS

SISTEMA DE PRENSAR CERTIFICADO



STASA

Suministros Industriales del Tajo, S.A.

ACCESORIOS DE PRESIÓN

ACERO INOXIDABLE AISI-316L (1.4404)

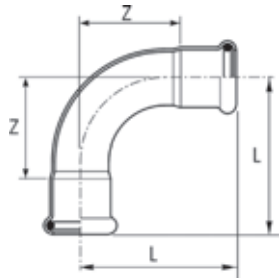

Código	D mm	L mm	z mm		Unidades bolsa
20C90HH015	15	50	30		20
20C90HH018	18	54	34		20
20C90HH022	22	60	39		10
20C90HH028	28	73	50		10
20C90HH035	35	86	60		5
20C90HH042	42	112	82		2
20C90HH054	54	138	103		2
20C90HH076	76	170	115		2
20C90HH088	88	195	135		2
20C90HH108	108	243	168		2

Curva 90° HH

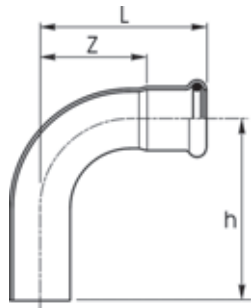

Código	D mm	L mm	z mm	h mm	Unidades bolsa
20C90HM015	15	50	30	62	20
20C90HM018	18	54	34	63	20
20C90HM022	22	60	39	71	10
20C90HM028	28	73	50	81	10
20C90HM035	35	121	60	100	5
20C90HM042	42	112	82	132	2
20C90HM054	54	138	103	152	2
20C90HM076	76	170	115	175	2
20C90HM088	88	195	135	204	2
20C90HM108	108	243	243	168	2

Curva 90° HM

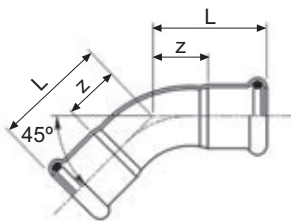

Código	D mm	L mm	z mm		Unidades bolsa
20C45HH015	15	36	15		20
20C45HH018	18	37	16		20
20C45HH022	22	41	20		20
20C45HH028	28	47	24		10
20C45HH035	35	54	45		10
20C45HH042	42	75	58		2
20C45HH054	54	91	56		2
20C45HH076	76	114	59		2
20C45HH088	88	129	69		2
20C45HH108	108	159	84		2

Curva 45° HH

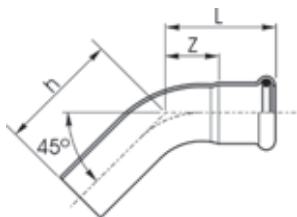

Código	D mm	L mm	z mm	h mm	Unidades bolsa
20C45HM015	15	36	15	49	20
20C45HM018	18	37	16	43,5	20
20C45HM022	22	41	20	48	20
20C45HM028	28	48	26	55	10
20C45HM035	35	55	23	68	10
20C45HM042	42	75	38	96	4
20C45HM054	54	91	56	107	2
20C45HM076	76	114	59	119	2
20C45HM088	88	129	69	137	2
20C45HM108	108	159	243	168	2

Curva 45° HM



ACCESORIOS DE PRESIÓN

ACERO INOXIDABLE AISI-316L (1.4404)

Codo 90 HH



Código	D mm	L mm	z mm			Unidades bolsa
20CD90HH035	35	69	43			5
20CD90HH042	42	78	48			5

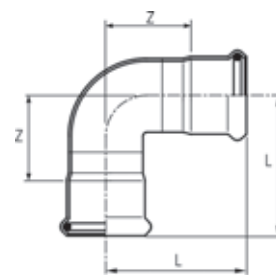

Manguito HH



Código	D mm	L mm	z mm			Unidades bolsa
20M015	15	49	9			20
20M018	18	50	10			20
20M022	22	52	10			20
20M028	28	56	10			10
20M035	35	62	10			10
20M042	42	72	12			4
20M054	54	83	13			2
20M076	76	142	32			2
20M088	88	166	46			2
20M108	108	203	41			2

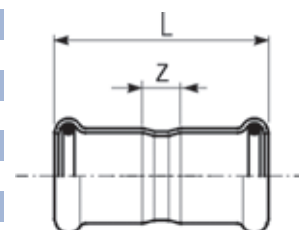

Reducción MH



Código	D mm	L mm	z mm			Unidades bolsa
20RE018015	18-15	57	37			20
20RE022015	22-15	64	44			20
20RE022018	22-18	59	39			20
20RE028015	28-15	76	56			20
20RE028018	28-18	74	54			20
20RE028022	28-22	65	44			20
20RE035015	35-15	88	68			10
20RE035018	35-18	81	61			10
20RE035022	35-22	73	52			10
20RE035028	35-28	71	48			10
20RE042015	42-15	90	70			4
20RE042018	42-18	91	71			4
20RE042022	42-22	89	68			4
20RE042028	42-28	87	64			4
20RE042035	42-35	80	54			4
20RE054015	54-15	101	81			4
20RE054018	54-18	102	82			4
20RE054022	54-22	94	73			4
20RE054028	54-28	104	81			4
20RE054035	54-35	94	68			4
20RE054042	54-42	92	62			4
20RE076054	76-54	147	112			4
20RE088054	88-54	160	125			4
20RE088076	88-76	184	129			4
20RE108054	108-54	177	142			2
20RE108076	108-76	202	147			2
20RE108088	108-88	206	146			2

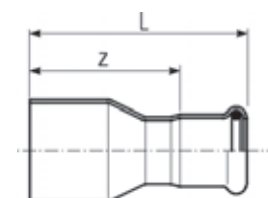

ACCESORIOS DE PRESIÓN

ACERO INOXIDABLE AISI-316L (1.4404)

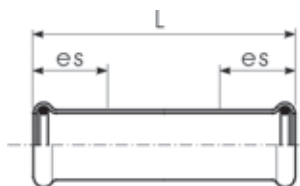

Código	D mm	L mm	es mm	Unidades bolsa
20MST015	15	80	25	20
20MST018	18	80	25	20
20MST022	22	84	25	20
20MST028	28	91	30	10
20MST035	35	102	30	10
20MST042	42	120	40	4
20MST054	54	140	40	4
20MST076	76	230	60	2
20MST088	88	260	70	2
20MST108	108	310	80	2

Manguito sin tope



Código	D mm	L1 mm	L2 mm	z1 mm	z2 mm	Unid. bolsa
20TR018015	18-15-18	37	41	16	21	20
20TR022015	22-15-22	40	43	18	23	20
20TR022018	22-18-22	40	44	18	24	10
20TR028015	28-15-28	44	46	21	26	10
20TR028018	28-18-28	44	47	21	26	10
20TR028022	28-22-28	44	48	28	27	10
20TR035015	35-15-35	51	49	22	30	5
20TR035018	35-18-35	51	50	22	30	5
20TR035022	35-22-35	51	51	22	30	5
20TR035028	35-28-35	51	54	22	31	5
20TR042022	42-22-42	59	54	28	33	4
20TR042028	42-28-42	59	57	28	34	4
20TR042035	42-35-42	59	61	28	35	4
20TR054022	54-22-54	70	62	34	40	2
20TR054028	54-28-54	70	65	34	42	2
20TR054035	54-35-54	70	69	34	42	2
20TR054042	54-42-54	70	72	34	42	2
20TR076022	76-22-76	118	74	62	53	2
20TR076028	76-28-76	118	77	62	54	2
20TR076035	76-35-76	118	84	62	54	2
20TR076042	76-42-76	118	84	62	54	2
20TR076054	76-54-76	118	90	62	55	2
20TR088022	88-22-88	132	81	72	60	2
20TR088028	88-28-88	132	84	72	61	2
20TR088035	88-35-88	132	88	72	62	2
20TR088042	88-42-88	132	92	72	62	2
20TR088054	88-54-88	132	98	72	63	2
20TR088076	88-76-88	132	125	72	70	2
20TR108022	108-22-108	155	91	74	70	2
20TR108028	108-28-108	155	94	74	71	2
20TR108035	108-35-108	155	98	74	72	2
20TR108042	108-42-108	155	101	74	71	2
20TR108054	108-54-108	155	107	74	72	2
20TR108076	108-76-108	155	135	74	80	2
20TR108088	108-88-108	155	141	74	81	2

Te reducida HHH

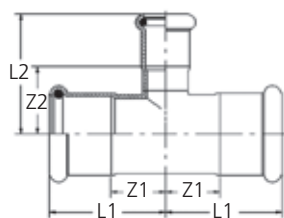

ACCESORIOS DE PRESIÓN ACERO INOXIDABLE AISI-316L (1.4404)

Te igual HHH



Código	D mm	L1 mm	L2 mm	z1 mm	z2 mm	Unidades bolsa
20T015	15	35	39	14	19	20
20T018	18	37	41	16	21	20
20T022	22	40	45	18	24	10
20T028	28	44	50	21	27	10
20T035	35	51	58	22	32	4
20T042	42	59	65	28	35	4
20T054	54	70	77	34	42	2
20T076	76	108	118	52	63	2
20T088	88	132	132	72	72	2
20T108	108	155	159	74	84	2

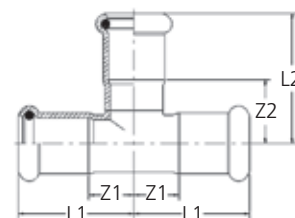

Te hembra roscada



Código	D mm	L1 mm	L2 mm	z1 mm	z2 mm	Unid. bolsa
20TH015015	15-1/2"-15	35	40	14	25	20
20TH018015	18-1/2"-18	37	42	16	27	20
20TH018020	18-3/4"-15	37	45	16	28	20
20TH022015	22-1/2"-22	40	44	18	29	10
20TH022020	22-3/4"-22	40	47	18	31	10
20TH028015	28-1/2"-28	44	47	21	32	10
20TH028020	28-3/4"-28	44	50	21	33	10
20TH028025	28-1"-28	44	53	21	34	5
20TH035015	35-1/2"-35	51	51	22	36	5
20TH035020	35-3/4"-35	51	54	22	37	5
20TH035025	35-1"-35	51	48	25	28	5
20TH042015	42-1/2"-42	59	54	28	39	4
20TH042020	42-3/4"-42	59	57	28	40	4
20TH054015	54-1/2"-54	70	61	34	46	2
20TH054020	54-3/4"-54	70	64	34	48	2
20TH054050	54-2"-54	70	81	34	55	2
20TH076020	76-3/4"-76	108	77	52	60	2
20TH076050	76-2"-76	108	93	52	67	2
20TH088020	88-3/4"-88	132	84	72	68	2
20TH088050	88-2"-88	132	101	72	75	2
20TH108020	108-3/4"-108	155	94	74	77	2
20TH108050	108-2"-108	155	110	74	84	2

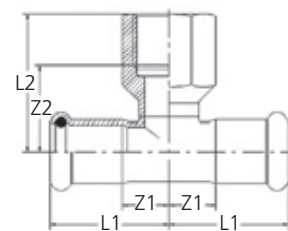

Codo macho



Código	D mm	L1 mm	L2 mm	z mm	Unidades bolsa
20CM015015	15-1/2"	37	57	37	10
20CM018015	18-1/2"	37	58	38	10
20CM022015	22-1/2"	39	58,5	37,5	10
20CM022020	22-3/4"	39	61	40	10
20CM028025	28-1"	44	68	45	5
20CM035032	35-1 1/4"	49	75	49	5
20CM042040	42-1 1/2"	54	84	54	2
20CM054050	54-2"	60	94	60	

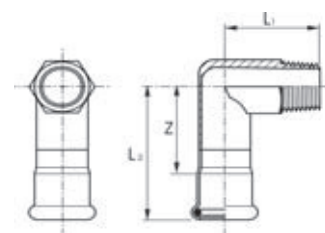

ACCESORIOS DE PRESIÓN

ACERO INOXIDABLE AISI-316L (1.4404)

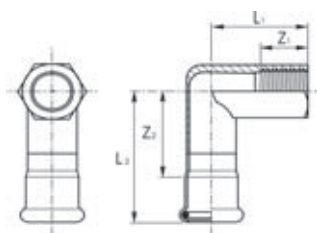

Código	D mm	L1 mm	L2 mm	z1 mm	z2 mm	Unidades bolsa
20CH015015	15-1/2"	38	57	15	37	10
20CH015020	15-3/4"	34	38	15	18	10
20CH018015	18-1/2"	39	58	15	38	10
20CH022015	22-1/2"	41	58,5	15	37,5	10
20CH022020	22-3/4"	46	61	27	40	10
20CH028015	28-1/2"	54	68	19	45	5
20CH028025	28-1"	54	68	35	45	5
20CH035032	35-1 1/4"	63	75	42	49	5

Codo hembra

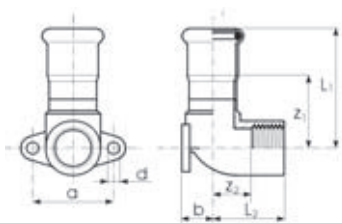

Código	D mm	L1 mm	L2 mm	z1 mm	a mm	Unidades bolsa
20CP015015	15 x 1/2"	50	30	30	34	20
20CP018015	18 x 1/2"	51	31	31	34	20
20CP022020	22 x 3/4"	55	34	34	40	10

Codo placa

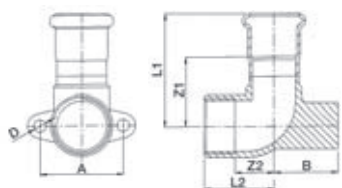

Código	D mm	L1 mm	L2 mm	z1 mm	z2 mm	A mm	B mm	D mm	Unidades bolsa
20CPD015015	15 x 1/2"	50	30	30	17	34	35	5	10
20CPD018015	18 x 1/2"	51	30	31	17	34	35	5	10
20CPD022020	22 x 3/4"	55	34	34	19	40	31	6	10
20CPD022025	22 x 1"	59	35	38	15	50	30	6	4
20CPD028025	28 x 1"	62	35	39	15	50	30	6	4

Codo distanciador

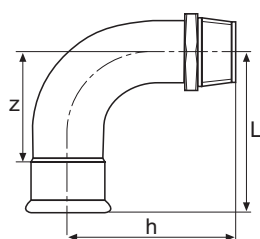
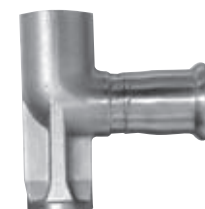

Código	D mm	L mm	z mm	h mm	Unidades bolsa
20CUM035025	35-1"	72	49	66	10
20CUM035032	35-1.1/4"	86	60	82	5
20CUM042032	42-1.1/4"	112	82	105	2

Curva macho

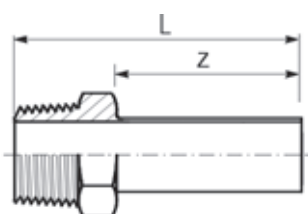

Código	D mm	L mm	z mm	Ex. mm	Unidades bolsa
20AM015015	15-1/2"	52	31	22	20
20AM018015	18-1/2"	52	31	22	20
20AM022015	22-1/2"	55	31	27	20
20AM018020	18-3/4"	55	32	27	10
20AM022020	22-3/4"	55	32	27	10

Adaptador macho

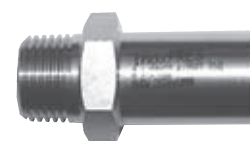

ACCESORIOS DE PRESIÓN

ACERO INOXIDABLE AISI-316L (1.4404)

Unión macho	Código	D mm	L mm	z mm	Ex. mm	Unidades bolsa
	20UM015010	15-3/8"	38	18	24	20
	20UM015015	15-1/2"	41	21	24	20
	20UM015020	15-3/4"	43	23	30	20
	20UM018015	18-1/2"	41	21	27	20
	20UM018020	18-3/4"	44	24	30	20
	20UM022015	22-1/2"	42	21	32	10
	20UM022020	22-3/4"	44	23	32	10
	20UM022025	22-1"	46	25	36	10
	20UM028020	28-3/4"	47	24	38	10
	20UM028025	28-1"	48	25	38	10
	20UM028032	28-1.1/4"	53	30	46	10
	20UM035025	35-1"	68	42	41	5
	20UM035032	35-1.1/4"	72	46	46	5
	20UM035040	35-1.1/2"	75	49	55	4
	20UM042032	42-1.1/4"	77	47	50	4
	20UM042040	42-1.1/2"	77	47	55	4
	20UM054040	54-1.1/2"	85	53	55	4
	20UM054050	54-2"	89	54	64	4
	20UM076065	76-2.1/2"	124	69		2
	20UM088080	88-3"	138	78		2
	20UM108100	108-4"	163	88	115	2

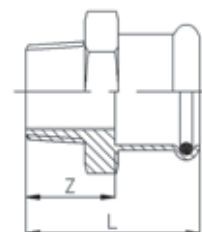

Mecanizada

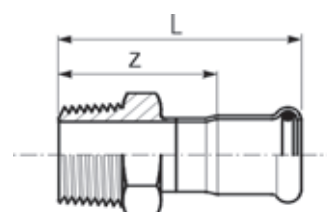

Soldada

Unión hembra	Código	D mm	L mm	z mm	Ex. mm	Unidades bolsa
	20UH015015	15-1/2"	38	5	27	20
	20UH015020	15-3/4"	39	5	32	20
	20UH018015	18-1/2"	38	5	27	20
	20UH018020	18-3/4"	39	5	32	10
	20UH022015	22-1/2"	39	5	32	20
	20UH022020	22-3/4"	40	5	32	10
	20UH022025	22-1"	43	5	41	10
	20UH028020	28-3/4"	42	5	38	10
	20UH028025	28-1"	45	5	41	10
	20UH028032	28-1.1/4"	48	5	46	10
	20UH035025	35-1"	64	19	38	5
	20UH035032	35-1.1/4"	75	27	46	5
	20UH035040	35-1.1/2"	76	29	55	4
	20UH042032	42-1.1/4"	71	20	46	4
	20UH042040	42-1.1/2"	79	27	55	4
	20UH054050	52-2"	97	36	70	4

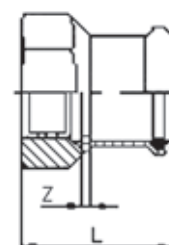

Mecanizada

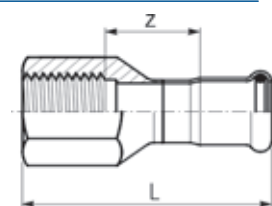

Soldada

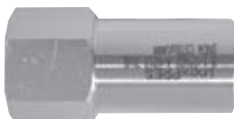
Adaptador hembra	Código	D mm	L mm	z mm	Ex. mm	Unidades bolsa
	20AH015015	15-1/2"	52	31	24	20
	20AH018015	18-1/2"	52	31	24	20
	20AH022015	22-1/2"	51	31	30	20
	20AH018020	18-3/4"	52	32	24	10
	20AH022020	22-3/4"	52	32	30	10
	20AH028020	28-3/4"	57	37	30	10

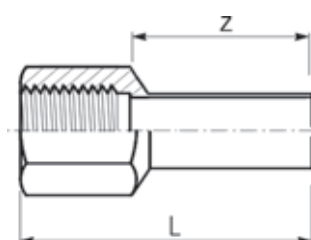

ACCESORIOS DE PRESIÓN

ACERO INOXIDABLE AISI-316L (1.4404)

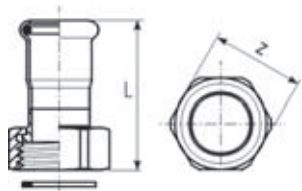

Código	D mm	L mm	z mm	Unidades bolsa
20R2P015015	15 -1/2"	53	27	10
20R2P015020	15 -3/4"	50	30	10
20R2P018015	18 -1/2"	53	27	10
20R2P018020	18 -3/4"	50	30	10
20R2P022025	22 -1"	52	36	10
20R2P028032	28 -1.1/4"	57	46	10
20R2P035040	35 -1.1/2"	63	52	4
20R2P042050	42 -2"	68	64	2
20R2P054050	54 -2"	72	67	2
20R2P054065	54 -2.1/2"	77	81	2

Rácor dos piezas



Junta EPDM

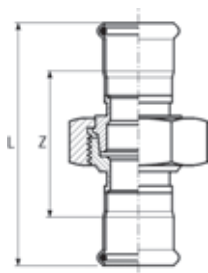

Código	D mm	L mm	z mm	Unidades bolsa
20R3P015	15	96	56	10
20R3P018	18	97	57	10
20R3P022	22	100	58	10
20R3P028	28	117	71	10
20R3P035	35	127	75	4
20R3P042	42	140	80	2
20R3P054	54	152	82	2

Rácor 3 Piezas

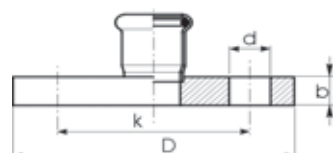

Código	Tubo mm	D mm	k mm	b mm	d mm	Unidades bolsa
20BA015	15	95	65	11	14	2
20BA018	18	95	65	11	14	2
20BA022	22	105	75	12	14	2
20BA028	28	115	85	14	14	2
20BA035	35	140	100	15	18	2
20BA042	42	150	110	16	18	2
20BA054	54	165	125	18	18	2
20BA076	76	185	145	18	18	1
20BA088	88	200	160	20	18	1
20BA108	108	220	180	20	18	1

Brida adaptador PN10/16

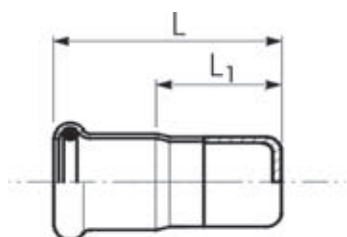

Código	D mm	L mm	L1 mm	Unidades bolsa
20TA015	15	44	24	20
20TA018	18	44	24	20
20TA022	22	45	24	10
20TA028	28	48	25	10
20TA035	35	52	26	5
20TA042	42	56	26	4
20TA054	54	62	27	4
20TA076	76	93	38	2
20TA088	88	99	39	2
20TA108	108	117	42	2

Tapón



ACCESORIOS DE PRESIÓN

ACERO INOXIDABLE AISI-316L (1.4404)

Curva desviación	Código	D mm	a mm	b mm	l mm	Unidades bolsa
	20CD015	15	158	42	57	10
	20CD018	18	166	44	60	10
	20CD022	22	189	48	76	10
	20CD028	28	201	54	74	10

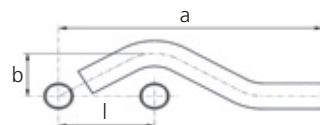

Tubo de aire	Código	Ø mm	A mm	B mm	C mm	E mm	R mm
	20TC015	15	140	70	30	30	35
	20TC018	18	140	80	35	50	40
	20TC022	22	140	80	35	50	40
	20TC028	28	150	102	40	60	51

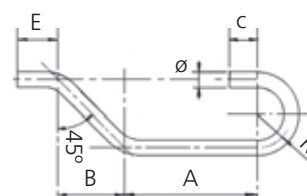

Dilatador	Código	D mm	L mm	z mm	A mm	Unidades bolsa
	20DI015	15	139	71	23	10
	20DI018	18	143	74	28	10
	20DI022	22	139	68	34	10
	20DI028	28	150	73	41	5
	20DI035	35	177	90	52	4
	20DI042	42	202	107	62	2
	20DI054	54	221	113	72	2

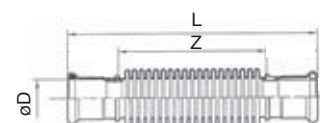

Válvula de bola "Pres"	Código	D mm	L mm	h mm	m mm	
	20V015	15	75	65	60	
	20V018	18	75	65	60	
	20V022	22	84	65	70	
	20V028	28	89	65	70	

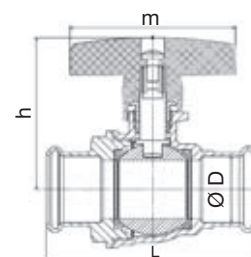

Válvula de bola 3 piezas "Pres"	Código	D mm	L mm	h mm	m mm	
	20V3C015	15	102	50	105	
	20V3C018	18	102	50	105	
	20V3C022	22	110	56	125	
	20V3C028	28	121	67	144	
	20V3C035	35	142	72	144	
	20V3C042	42	158	93	189	
	20V3C054	54	186	101	189	
	20V3C076	76	252	125	224	
	20V3C088	88	282	135	224	
	20V3C108	108	336	168	298	

NOVEDAD

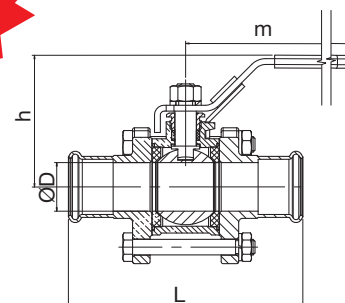

ACCESORIOS DE PRESIÓN

ACERO CARBONO GALVANIZADO

Tubo de acero carbono según norma EN-10305-3

Material:

Tubo galvanizado exterior E220CR2S3 (1.0215)

Tubo galvanizado exterior e interior E190CR2S4 (1.0031)

Temperatura:

- máx. 90°C

- mín. -5°C

Coefficiente de dilatación: 0,012 mm para $\Delta t=1^\circ\text{C}$

Código Galv. int.-ext.	Código Galv. ext.	D mm	Espesor	Peso	Long. barra
14ST015x12	15ST015x12	15	1,2	0,434	6
14ST018x12	15ST018x12	18	1,2	0,536	6
14ST022x15	15ST022x15	22	1,5	0,824	6
14ST028x15	15ST028x15	28	1,5	1,052	6
14ST035x15	15ST035x15	35	1,5	1,320	6
14ST042x15	15ST042x15	42	1,5	1,620	6
14ST054x15	15ST054x15	54	1,5	2,098	6
14ST076x20	15ST076x20	76	2,0	3,720	6
14ST088x20	15ST088x20	88	2,0	4,330	6
15ST108x20	15ST108x20	108	2,0	5,260	6

Tubo de acero galvanizado

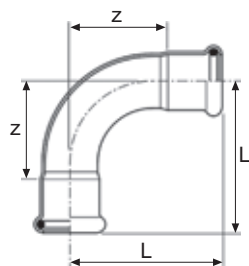

Código	D mm	L mm	z mm	Unid. bolsa
22C90HH015	15	50	30	20
22C90HH018	18	54	34	20
22C90HH022	22	60	39	10
22C90HH028	28	73	50	10
22C90HH035	35	86	60	5
22C90HH042	42	112	82	2
22C90HH054	54	138	103	2
22C90HH076	76	170	115	2
22C90HH088	88	195	135	2
22C90HH108	108	243	168	2

Curva 90° HH

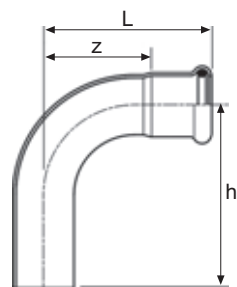

Código	D mm	L mm	z mm	h mm	Unid. bolsa
22C90HM015	15	50	30	62	20
22C90HM018	18	54	34	63	20
22C90HM022	22	60	39	71	10
22C90HM028	28	73	50	81	10
22C90HM035	35	121	60	100	5
22C90HM042	42	112	82	132	2
22C90HM054	54	138	103	152	2
22C90HM076	76	170	115	175	2
22C90HM088	88	195	135	204	2
22C90HM108	108	243	243	168	2

Curva 90° HM

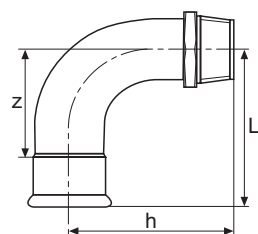

Código	D mm	L mm	z mm	h mm	Unid. bolsa
22CUM015010	15-3/8"	49	29	37	20
22CUM015015	15-1/2"	49	29	40	20
22CUM018015	18-1/2"	53	33	47	20
22CUM022020	22-3/4"	61	40	54	10
22CUM028025	28-1"	72	49	66	10
22CUM035032	35-1.1/4"	86	60	82	5
22CUM042040	42-1.1/2"	112	82	105	2
22CUM054050	54-2"	138	103	129	2

Curva macho



ACCESORIOS DE PRESIÓN ACERO CARBONO GALVANIZADO

Curva 45° HH



Código	D mm	L mm	z mm	Unid. bolsa
22C45HH015	15	36	15	20
22C45HH018	18	37	16	20
22C45HH022	22	41	20	20
22C45HH028	28	47	24	10
22C45HH035	35	54	45	10
22C45HH042	42	75	58	2
22C45HH054	54	91	56	2
22C45HH076	76	114	59	2
22C45HH088	88	129	69	2
22C45HH108	108	159	84	2

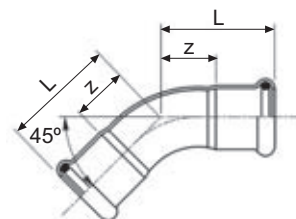

Curva 45° HM



Código	D mm	L mm	z mm	h mm	Unid. bolsa
22C45HM015	15	36	15	49	20
22C45HM018	18	37	16	43,5	20
22C45HM022	22	41	20	48	20
22C45HM028	28	48	26	55	10
22C45HM035	35	55	23	68	10
22C45HM042	42	75	38	96	4
22C45HM054	54	91	56	107	2
22C45HM076	76	114	59	119	2
22C45HM088	88	129	69	137	2
22C45HM108	108	159	243	168	2

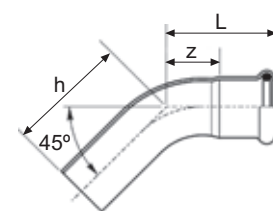

Codo macho 90°



Código	D mm	L mm	z mm	h mm	Unid. bolsa
22COM015010	15-3/8"	36	16	21	20
22COM015015	15-1/2"	37	17	26	20
22COM018015	18-1/2"	37	17	26	20
22COM022020	22-3/4"	41	20	29	10

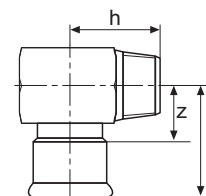

Codo hembra 90°



Código	D mm	L mm	z mm	h mm	Unid. bolsa
22COH022020	22-3/4"	46	25	44	20
22COH028015	28-1/2"	49	26	42	20
22COH028020	28-3/4"	49	26	47	20

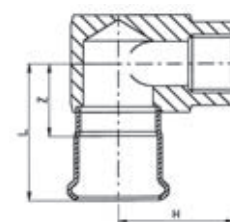

ACCESORIOS DE PRESIÓN ACERO CARBONO GALVANIZADO

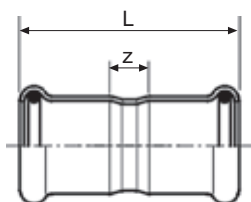

Código	D mm	L mm	z mm	Unid. bolsa
22M015	15	49	9	20
22M018	18	50	10	20
22M022	22	52	10	20
22M028	28	56	10	10
22M035	35	62	10	10
22M042	42	72	12	4
22M054	54	83	13	4
22M076	76	142	32	4
22M088	88	166	46	4
22M108	108	203	41	2

Manguito HH

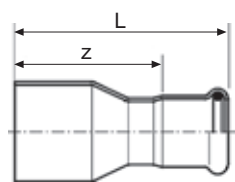

Código	D mm	L mm	z mm	Unid. bolsa
22RE018015	18-15	57	37	20
22RE022015	22-15	64	44	20
22RE022018	22-18	59	39	20
22RE028015	28-15	76	56	20
22RE028018	28-18	74	54	20
22RE028022	28-22	65	44	20
22RE035022	35-22	73	52	10
22RE035028	35-28	71	48	10
22RE042028	42-28	93	70	4
22RE042035	42-35	80	54	4
22RE054022	54-22	94	73	4
22RE054028	54-28	104	81	4
22RE054035	54-35	108	82	4
22RE054042	54-42	92	62	4
22RE076054	76-54	147	112	4
22RE088054	88-54	160	125	4
22RE088076	88-76	184	129	4
22RE108076	108-76	202	147	2
22RE108088	108-88	206	146	2

Reducción MH

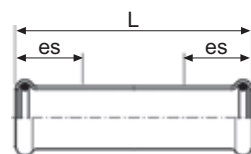

Código	D mm	L mm	es mm	Unid. bolsa
22MST015	15	80	25	20
22MST018	18	80	25	20
22MST022	22	84	25	20
22MST028	28	91	30	10
22MST035	35	102	30	10
22MST042	42	120	40	4
22MST054	54	140	40	4
22MST076	76	230	60	2
22MST088	88	260	70	2
22MST108	108	310	80	2

Manguito sin tope



ACCESORIOS DE PRESIÓN ACERO CARBONO GALVANIZADO

Te igual HHH



Código	D mm	L1 mm	L2 mm	z1 mm	z2 mm	Unid. bolsa
22T015	15	35	39	14	19	20
22T018	18	37	41	16	21	20
22T022	22	40	45	18	24	20
22T028	28	44	50	21	27	10
22T035	35	51	58	22	32	4
22T042	42	59	65	28	35	4
22T054	54	70	77	34	42	2
22T076	76	108	118	52	63	2
22T088	88	132	132	72	72	2
22T108	108	155	159	74	84	2

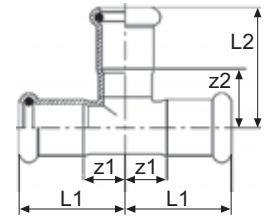

Te reducida HHH



Código	D mm	L1 mm	L2 mm	z1 mm	z2 mm	Unid. bolsa
22TR018015	18-15-18	37	41	16	21	20
22TR022015	22-15-22	40	43	18	23	20
22TR022018	22-18-22	40	44	18	24	10
22TR028015	28-15-28	44	46	21	26	10
22TR028018	28-18-28	44	47	21	26	10
22TR028022	28-22-28	44	48	28	27	10
22TR035015	35-15-35	51	49	22	30	5
22TR035018	35-18-35	51	50	22	30	5
22TR035022	35-22-35	51	51	22	30	5
22TR035028	35-28-35	51	54	22	31	5
22TR042022	42-22-42	59	54	28	33	4
22TR042028	42-28-42	59	57	28	34	4
22TR042035	42-35-42	59	61	28	35	4
22TR054022	54-22-54	70	62	34	40	2
22TR054028	54-28-54	70	65	34	42	2
22TR054035	54-35-54	70	69	34	42	2
22TR054042	54-42-54	70	72	34	42	2
22TR076022	76-22-76	108	74	52	53	2
22TR076028	76-28-76	118	77	62	54	2
22TR076035	76-35-76	118	84	62	54	2
22TR076042	76-42-76	118	84	62	54	2
22TR076054	76-54-76	118	90	62	55	2
22TR088022	88-22-88	132	81	72	60	2
22TR088028	88-28-88	132	84	72	61	2
22TR088035	88-35-88	132	88	72	62	2
22TR088042	88-42-88	132	92	72	62	2
22TR088054	88-54-88	132	98	72	63	2
22TR088076	88-76-88	132	125	72	70	2
22TR108028	108-28-108	155	94	74	71	2
22TR108035	108-35-108	155	98	74	72	2
22TR108042	108-42-108	155	101	74	71	2
22TR108054	108-54-108	155	107	74	72	2
22TR108076	108-76-108	155	135	74	80	2
22TR108088	108-88-108	155	141	74	81	2

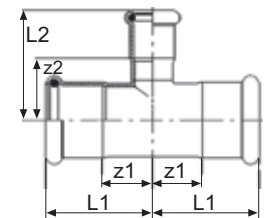

ACCESORIOS DE PRESIÓN ACERO CARBONO GALVANIZADO

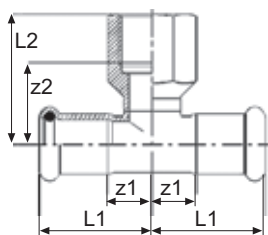

Código	D mm	L1 mm	L2 mm	z1 mm	z2 mm	Unid. bolsa
22TH015015	15-1/2"-15	35	40	14	25	20
22TH018015	18-1/2"-18	37	42	16	27	20
22TH022015	22-1/2"-22	40	44	18	29	10
22TH028015	28-1/2"-28	44	47	21	32	10
22TH028020	28-3/4"-28	44	50	21	33	10
22TH028025	28-1"-28	44	53	21	34	5
22TH035015	35-1/2"-35	51	51	22	36	5
22TH035020	35-3/4"-35	51	54	22	37	5
22TH035025	35-1"-35	51	48	25	28	5
22TH042015	42-1/2"-42	59	54	28	39	4
22TH042020	42-3/4"-42	59	57	28	40	4
22TH054015	54-1/2"-52	70	61	34	46	2
22TH054020	54-3/4"-54	70	64	34	48	2
22TH076020	76-3/4"-76	108	77	52	60	2
22TH076015	76-1/2"-76	108				2
22TH088020	88-3/4"-88	132	84	72	68	2
22TH088015	88-1/2"-88	132				2
22TH108020	108-3/4"-108	155	94	74	77	2
22TH108015	108-1/2"-108	155				2

Te hembra roscada



Código	D mm	L mm	z mm	Unid. bolsa
22UM015010	15-3/8"	41	21	20
22UM015015	15-1/2"	43	23	20
22UM015020	15-3/4"	43	23	20
22UM018015	18-1/2"	41	21	20
22UM018020	18-3/4"	44	24	20
22UM022015	22-1/2"	42	21	10
22UM022020	22-3/4"	44	23	10
22UM022025	22-1"	46	25	10
22UM028020	28-3/4"	47	24	10
22UM028025	28-1"	48	25	10
22UM028032	28-1.1/4"	52	29	10
22UM035025	35-1"	52	25	5
22UM035032	35-1.1/4"	72	46	4
22UM035040	35-1.1/2"	55	28	5
22UM042040	42-1.1/2"	77	47	4
22UM054050	54-2"	89	54	4
22UM076065	76-2.1/2"	124	69	2
22UM088080	88-3"	138	78	2
22UM108100	108-4"	138	78	2

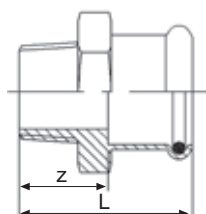

Unión macho



Código	D mm	L mm	z mm	Unid. bolsa
22UH015010	15-3/8"	35	2	20
22UH015015	15-1/2"	38	5	20
22UH015020	15-3/4"	39	2	20
22UH018015	18-1/2"	38	5	20
22UH018020	18-3/4"	39	5	10
22UH022020	22-3/4"	40	5	10
22UH022025	22-1"	43	2	10
22UH028015	28-1/2"	42	5	10
22UH028020	28-3/4"	42	2	10
22UH028025	28-1"	45	5	10
22UH035025	35-1"	51	2	5
22UH035032	35-1.1/4"	52	2	5
22UH042040	42-1.1/2"	56	2	4
22UH054050	54-2"	65	2	4

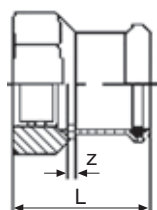

Unión hembra



ACCESORIOS DE PRESIÓN ACERO CARBONO GALVANIZADO

Rácor dos piezas



Junta EPDM

Código	D mm	L mm	z mm	Unid. bolsa
22R2P015020	15-3/4"	37	30	10
22R2P015020	18-3/4"	37	30	10
22R2P022025	22-1"	40	36	10
22R2P028032	28-1.1/4"	47	46	10
22R2P035040	35-1.1/2"	52	55	4

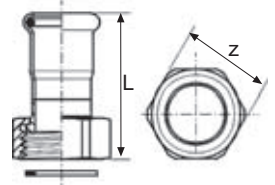

Tapón



Código	D mm	L mm	L1 mm	Unid. bolsa
22TA015	15	44	24	20
22TA018	18	44	24	20
22TA022	22	45	24	10
22TA028	28	48	25	10
22TA035	35	52	26	5
22TA042	42	56	26	4
22TA054	54	62	27	4
22TA076	76	93	38	2
22TA088	88	99	39	2
22TA108	108	117	42	2

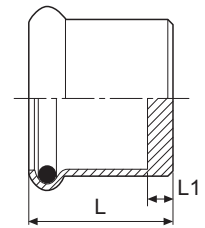

Curva desviación



Código	D mm	a mm	b mm	l mm	Unid. bolsa
22CD015	15	158	42	57	10
22CD018	18	166	44	60	10
22CD022	22	189	48	76	10
22CD028	28	201	54	74	10

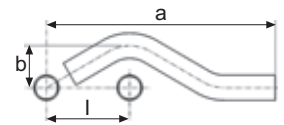

Adaptador hembra



Código	D mm	z mm	h mm	Unid. bolsa
22AH015015	15-1/2"	48	61	20
22AH018015	18-1/2"	48	61	20
22AH018020	18-3/4"	50	64	20
22AH022015	22-1/2"	49	62	20
22AH022020	22-3/4"	51	65	20

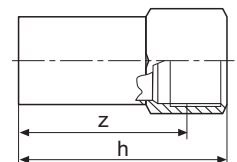

Brida adaptador PN10/16



Código	Tubo mm	D mm.	k mm	b mm	d mm	Unid. bolsa
22BA015	15	95	65	11	14	2
22BA018	18	95	65	11	14	2
22BA022	22	105	75	12	14	2
22BA028	28	115	85	14	14	2
22BA035	35	140	100	15	18	2
22BA042	42	150	110	16	18	2
22BA054	54	165	125	18	18	2
22BA076	76	185	145	18	18	1
22BA088	88	200	160	20	18	1
22BA108	108	220	180	20	18	1

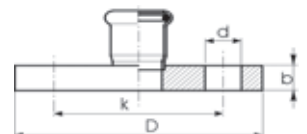

ACCESORIOS DE PRESIÓN

ACERO INOXIDABLE AISI-316L (1.4404)

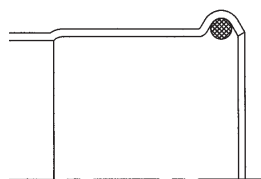

Junta tradicional

Código	D mm	s mm	Unidades bolsa
20EPDM015	15	3	20
20EPDM018	18	3	20
20EPDM022	22	4	20
20EPDM028	28	4	20
20EPDM035	35	4	20
20EPDM042	42	5	20
20EPDM054	54	5	20
20EPDM076	76	7	5
20EPDM088	88	8	5
20EPDM108	108	10	5

Junta tórica EPDM (negra)

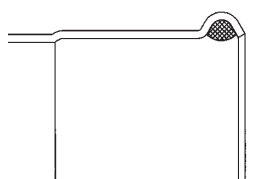

Junta INOXPRES

Código	D mm	s mm	Unidades bolsa
20VIT015	15	3	20
20VIT018	18	3	20
20VIT022	22	4	20
20VIT028	28	4	20
20VIT035	35	4	20
20VIT042	42	5	20
20VIT054	54	5	20
20VIT076	76	7	5
20VIT088	88	8	5
20VIT108	108	10	5

Junta tórica FKM (verde)

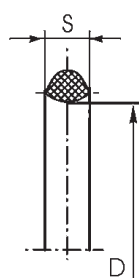

Código	D mm	s mm	Unidades bolsa
20NBR015	15	3	20
20NBR018	18	3	20
20NBR022	22	4	20
20NBR028	28	4	20
20NBR035	35	4	20
20NBR042	42	5	20
20NBR054	54	5	20
20NBR076	76	7	5
20NBR088	88	8	5
20NBR108	108	10	5

Junta tórica NBR (amarilla)

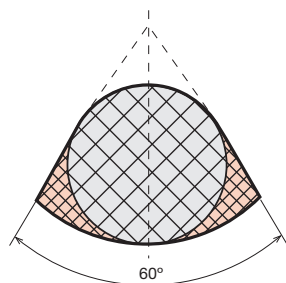

Mejora del 20 %

Código	D mm	s mm	Unidades bolsa
20MVQ022	22	4	20
20MVQ028	28	4	20
20MVQ035	35	4	20
20MVQ042	42	5	20
20MVQ054	54	5	20

Junta tórica MVQ (roja)



ACCESORIOS DE PRESIÓN ACERO INOXIDABLE AISI-316L (1.4404)

Abrazadera PRES

Acero Inoxidable EN 1.4404/316L

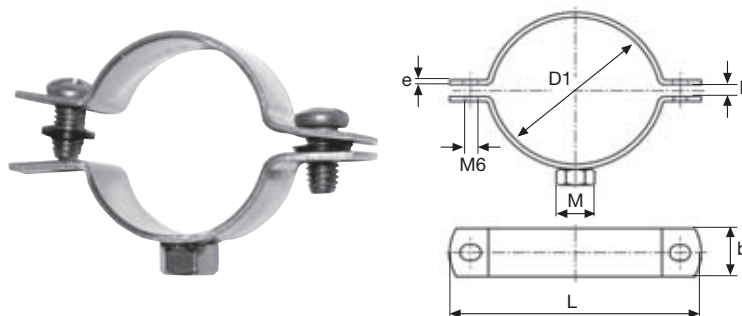

Código	D1 mm	h mm	M	b mm	L mm	e mm	Unid. caja	Peso kg/u.
40AP1015	15	2	M6	16	48	1,5	50	0,025
40AP1018	18	2	M6	16	53	1,5	50	0,027
40AP1022	22	2	M6	16	58	1,5	50	0,030
40AP1028	28	3	M6	16	63	1,5	50	0,033
40AP1035	35	3	M6	16	72	1,5	25	0,040
40AP1042	42	4	M8	16	82	1,5	25	0,044
40AP1054	54	4	M8	16	94	1,5	25	0,057
402AC065	76	7	M10	30	115	2,5	20	0,187
402AC080	88	7	M10	30	130	2,5	20	0,212
402AC100	108	15	M10	30	170	2,5	20	0,274

Espárrago AISI - 304

Acero Inoxidable EN 1.4307/304

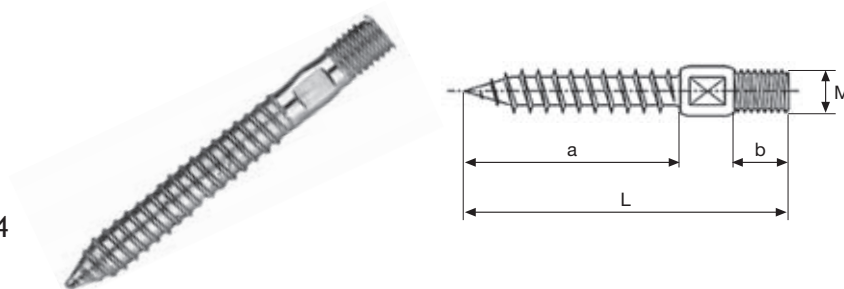

Código	M mm	L mm	b mm	a mm	Unidades caja	Peso kg/u.
46EM06X40	M6	50	7	35		0,008
46EM08X50	M8	60	9	40		0,016
46EM10X60	M10	75	11	52		0,027

VÁLVULAS DE BOLA

ACERO INOXIDABLE AISI-316E (1.4408)

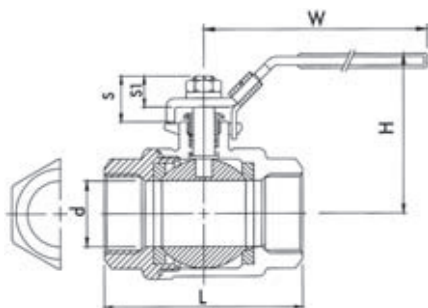

Dos piezas
paso total

Acero Inoxidable EN 1.4408/316

Código	D1	d mm	L mm	H mm	W mm	Peso kg/u.
62V2C008	1/4"	11,6	49,0	51	105	0,27
62V2C010	3/8"	12,7	49,0	51	105	0,27
62V2C015	1/2"	15,0	57,0	53	105	0,32
62V2C020	3/4"	20,0	65,0	59	125	0,50
62V2C025	1"	25,0	78,0	73	160	0,82
62V2C032	1.1/4"	32,0	90,5	78	160	1,25
62V2C040	1.1/2"	38,0	105,0	91	190	1,93
62V2C050	2"	50,0	127,0	99	190	3,10
62V2C065	2.1/2"	65,0	160,0	130	245	6,47
62V2C080	3"	80,0	187,0	142	245	10,75

HERRAMIENTAS

Máquina electro/hidráulica UNP2

Mordaza giratoria y retroceso automático

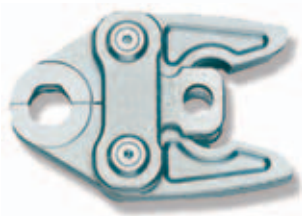

Mordazas

Gama de Ø 15 a Ø 35



Mordaza cadena

Gama de Ø 42 y Ø 54

SUPERSIZE

Máquina electrohidráulica UAP100

Mordaza giratoria y retroceso automático



Ø 76



Ø 88



Ø 108



GRUPO HIDRÁULICO EHP2SAN1B

Potencia: 0,75 Kw
 Voltaje motor: 230V - 50 Hz
 Capacidad: 0,91 l/min
 Presión de Trabajo: max 700 bar

Manguera hidráulica de 5m longitud.
 Cable eléctrico de 10m longitud.
 Carro de transporte.



Ejemplo de prensado

MÉTODO DE MONTAJE



1
Cortar el tubo a medida.



2
Quitar la rebaba para evitar dañar la junta tórica.



3
Comprobar la presencia de la junta tórica en el accesorio.



4
Introducir el tubo en el accesorio, girando y empujando hasta hacer tope.



5
Hacer una marca en el tubo para posteriormente asegurar el prensado.



6
Montar la mordaza con perfil (M), correspondiente al diámetro del tubo.



7
Abrir la mordaza y colocarla en el accesorio.



8
Efectuar el prensado.



9
Comprobar la correcta unión.

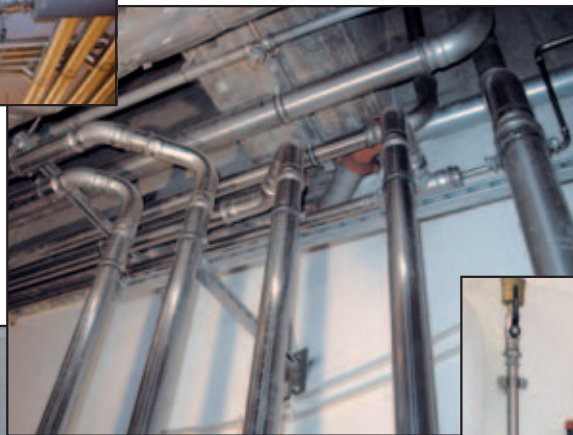

OTROS PRODUCTOS

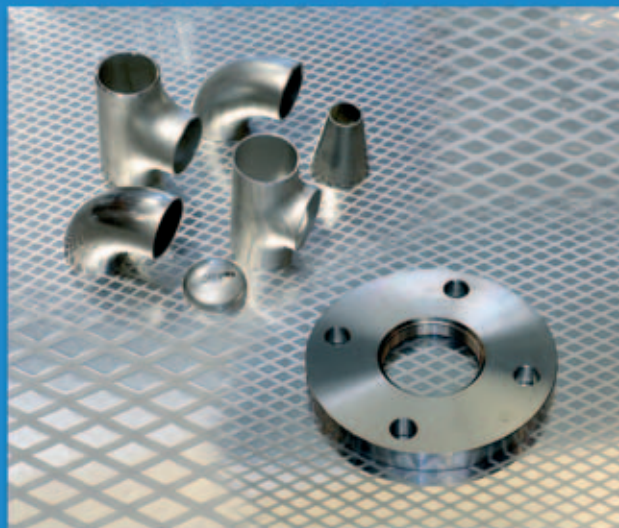
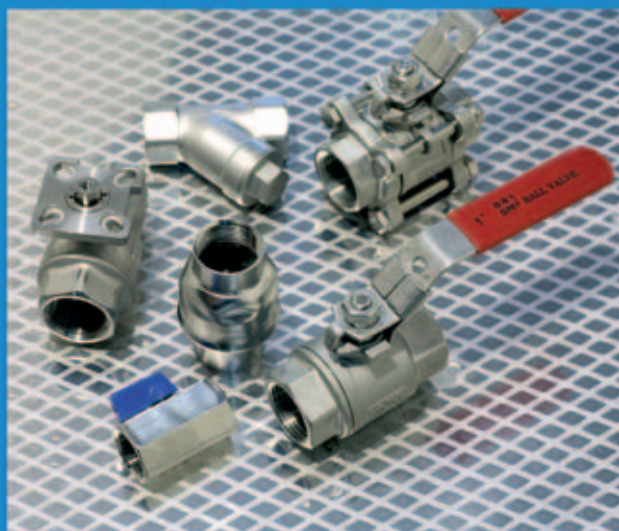

SITASA

Suministros Industriales del Tajo, S.A.

Suministros Industriales del Tajo S.A.
C/ del Río Jarama 52 - 45007, Toledo - Spain
Tel.: 925 23 22 00 - Fax: 925 23 21 47
Email: sitasa@sitasa.com
www.sitasa.com